

PC board drilling dimensions (after plating)  
(thickness < 3.20 ± 0.30mm)

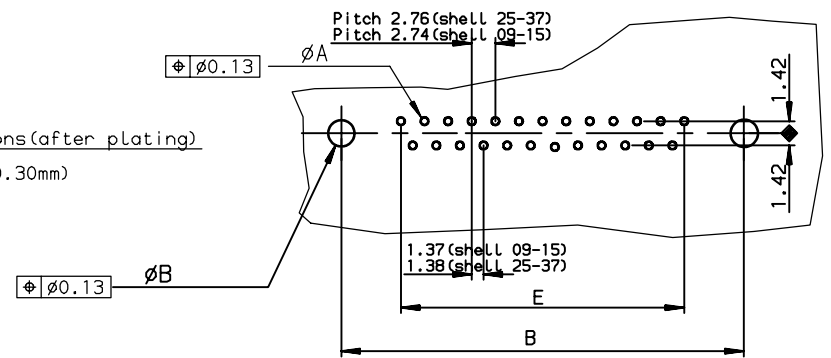

TIN LEAD PART NUMBER

| SHELL | A±0.38 | B±0.12 | C±0.10 | D±0.25 | E±0.07 | PART NUMBER  | PART NUMBER  |
|-------|--------|--------|--------|--------|--------|--------------|--------------|
| 09    | 30.81  | 24.99  | 16.96  | 16.21  | 10.96  | D09S90C4PV00 | D09S90C6PV00 |
| 15    | 39.14  | 33.32  | 25.18  | 24.54  | 19.18  | D15S90C4PV00 | D15S90C6PV00 |
| 25    | 53.03  | 47.04  | 39.12  | 38.25  | 33.12  | D25S90C4PV00 | D25S90C6PV00 |
| 37    | 69.32  | 63.50  | 55.68  | 54.71  | 49.68  | D37S90C4PV00 | D37S90C6PV00 |
|       |        |        |        |        |        | gold flash   | 0.76µ gold   |

LEAD FREE PART NUMBER

| SHELL | A±0.38 | B±0.12 | C±0.10 | D±0.25 | E±0.07 | PART NUMBER    | PART NUMBER    |
|-------|--------|--------|--------|--------|--------|----------------|----------------|
| 09    | 30.81  | 24.99  | 16.96  | 16.21  | 10.96  | D09S90C4PV00LF | D09S90C6PV00LF |
| 15    | 39.14  | 33.32  | 25.18  | 24.54  | 19.18  | D15S90C4PV00LF | D15S90C6PV00LF |
| 25    | 53.03  | 47.04  | 39.12  | 38.25  | 33.12  | D25S90C4PV00LF | D25S90C6PV00LF |
| 37    | 69.32  | 63.50  | 55.68  | 54.71  | 49.68  | D37S90C4PV00LF | D37S90C6PV00LF |
|       |        |        |        |        |        | gold flash     | 0.76µ gold     |

GENERAL CHARACTERISTICS AND ROHS INFORMATIONS:  
SEE DRAWING C01-8646-0001

European Views

|                                       |        |                                     |                                   |                         |
|---------------------------------------|--------|-------------------------------------|-----------------------------------|-------------------------|
| www.fciconnect.com                    |        | surface<br>ISO 1302 ✓               | tolerance std<br>ISO 406 ISO 1101 | projection<br>mm        |
| TOLERANCES UNLESS OTHERWISE SPECIFIED |        |                                     |                                   |                         |
| Dr                                    | PESSON | 1991/07/19                          | 0.X ±0.1                          | size<br>A3              |
| Eng                                   | PESSON | 1991/07/19                          | 0.XX ±0.1                         |                         |
| Chr                                   | LEGARE | 1991/07/19                          | 0.XX' ±2'                         | ECN<br>LS06-0140        |
| Appr                                  | LEGARE | 1991/07/19                          | Product family                    |                         |
|                                       |        |                                     | D-SUB                             | Spec ref -              |
| FCI                                   |        | FEMALE CONNECTOR DELTA D LOW PROFIL |                                   | Rev.<br>G               |
|                                       |        | straight press-fit                  |                                   | dwg no<br>C01-8646-0034 |
| catalog no                            |        |                                     |                                   | CUSTOMER sheet 1 of 1   |

| rev | ecn no    | dr  | date       |
|-----|-----------|-----|------------|
| D   | -         | -   | 1997/07/23 |
| E   | LS05-004  | MPE | 2005/02/07 |
| F   | LS06-0095 | LGO | 2006/06/17 |
| G   | LS06-0140 | LGO | 2006/09/22 |
| -   | -         | -   | -          |
| -   | -         | -   | -          |
| -   | -         | -   | -          |

Copyright FCI.